

# LAKEVIEW

BUSINESS PARK

*A Premier Office & Warehouse Development*

14623 Fairway Pines Drive



## BUILDING 3 - 152,844 SF - FOR SALE OR LEASE



### BUILDING FEATURES:

- 30' Clear Height
- LEED® Precertified for Core & Shell
- Concrete Tiltwall Structure
- ESFR Fire Protection
- 6" Steel Reinforced Concrete Floor Slab
- 52' x 50' Typical Bay Size (60' at loading bay)
- 48" Dock Height
- Thirty-Six 9' x 10' Dock Doors and Six 14' x 14' Oversize Doors
- 161 Parking Spaces
- All Concrete Paving
- 120' Truck Court



Precertified under the LEED® Green Building Certification System

*Located in rapidly growing Fort Bend County, Lakeview Business Park is the premier light industrial development set in a unique and natural environment created by preserved mature trees and neighboring lakes.*

*The 157 acre park in Missouri City, Texas, offers convenient access to the Sam Houston Parkway, U.S. Highway 90-A and the Fort Bend Parkway, and is positioned to effectively serve the entire Houston area.*

For more information please visit:

[www.lakeviewbp.com](http://www.lakeviewbp.com)

*A Development of*

TrammellCrowCompany and CROW HOLDINGS REALTY PARTNERS IV, L.P.

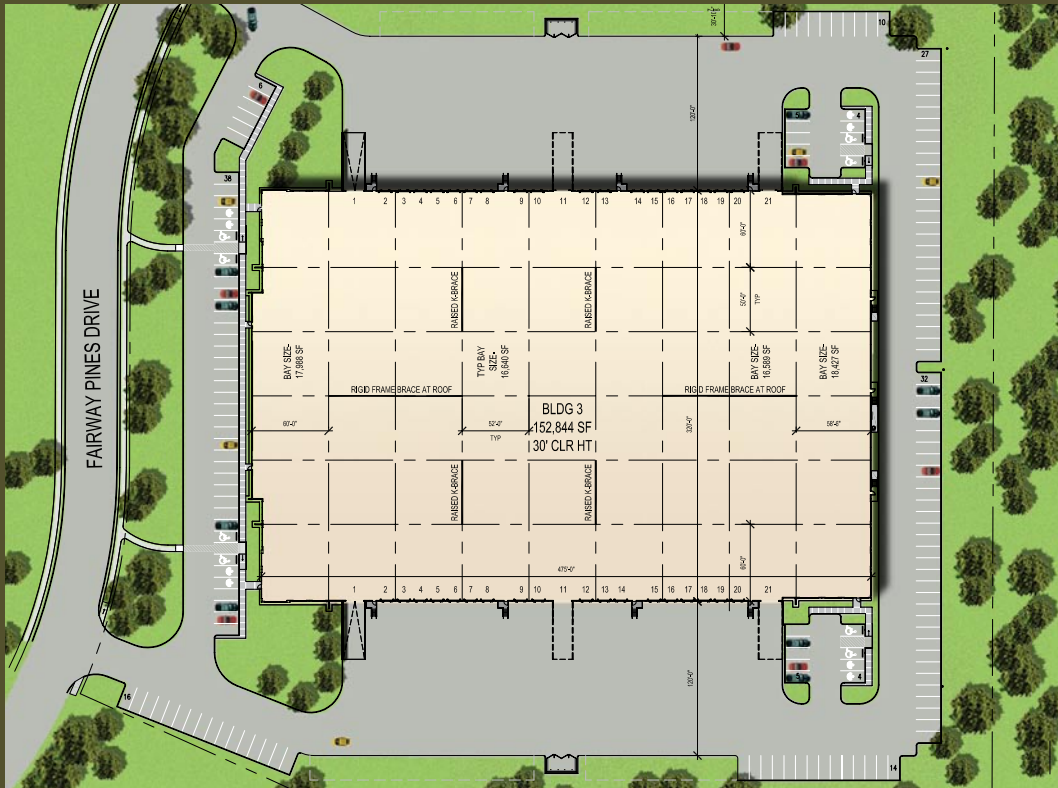

The information above has been obtained from sources believed reliable. While we do not doubt its accuracy, we have not verified it and make no guarantee, warranty or representation about it. It is your responsibility to independently confirm its accuracy and completeness. Any projections, opinions, assumptions or estimates used are for example only and do not represent the current or future performance of the property. The value of this transaction to you depends on tax and other factors which should be evaluated by you, your tax, financial and legal advisors. You and your advisors should conduct a careful, independent investigation of the property to determine to your satisfaction the suitability of the property for your needs.  
 © CB Richard Ellis, Printed in USA, 09/09, HOU0001466

**LEASING / SALES INFO**

**Faron Wiley**  
 713.577.1839  
 faron.wiley@cbre.com

**Steve King**  
 713.577.1617  
 steve.king@cbre.com

**Joseph Smith**  
 713.577.1847  
 joseph.smith@cbre.com

CB Richard Ellis  
 2800 Post Oak Blvd  
 Suite 2300  
 Houston, Texas 77056

